

# 6x 6 foot Butterfly Garden

$\frac{3}{4}$  inch = 1 foot

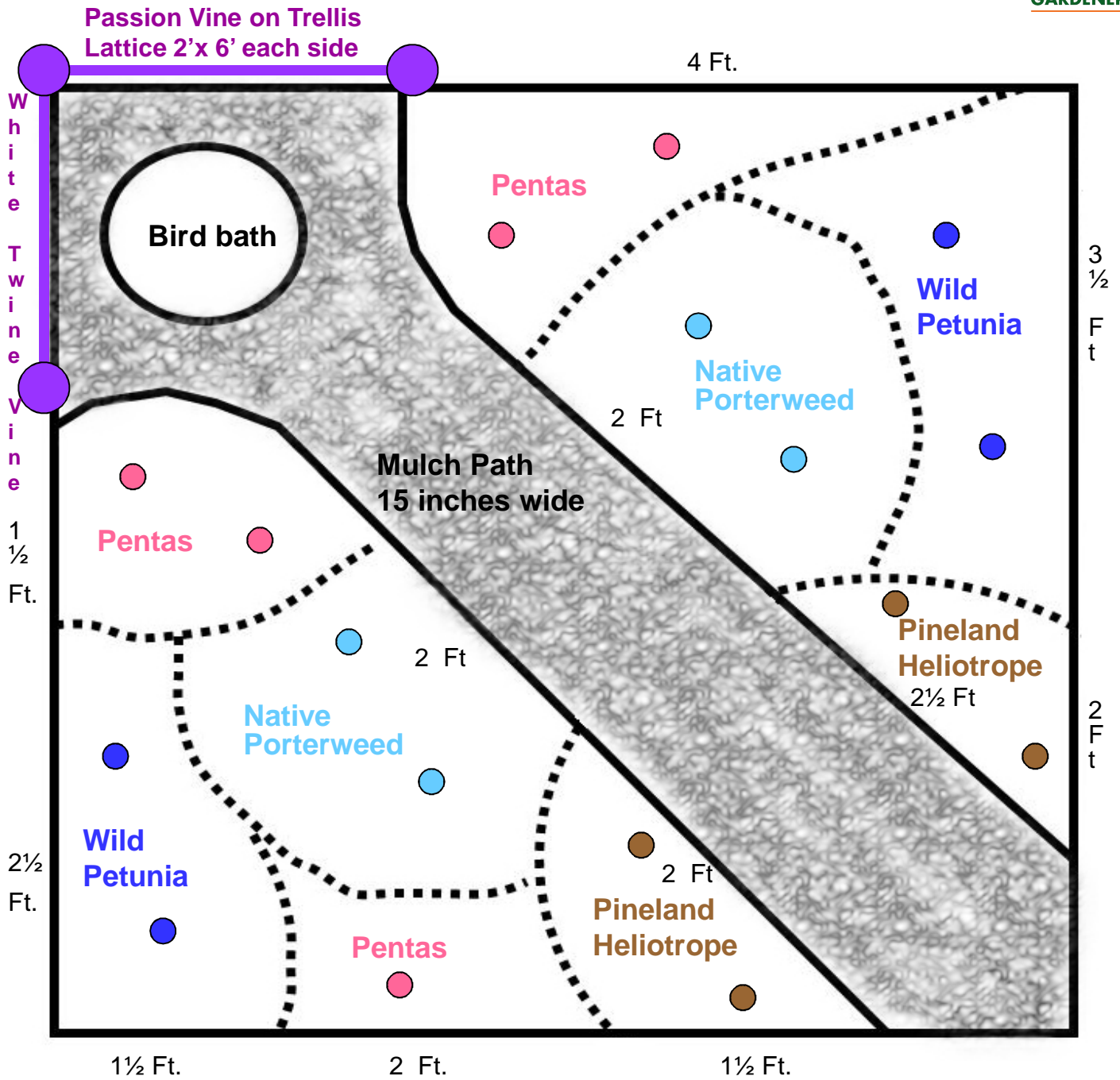

Graphics by Sandra L. Granson  
Plan by Lee Hainline Master Gardener



## Plant List

- 4 Native Porterweed *Stachytarpheta jamaicensis*
- 4 Wild *Ruellia caroliniensis*
- 5 Pentas *Pentas lanceolata*
- 4 Pineland Heliotrope *Heliotropium polyphyllum*
- 1 Passion Vine *Passiflora incarnata*, *P. suberosa*, or *P. incarnata* x *cinnicata* 'Incense'
- 1 White Twine Vine *Sarcostemma clausum*

## Hardscape

- Mulch
- Corner trellis of (2) 2 x 6ft. Lattice and posts
- Birdbath or something of architectural interest for the circular area

## Garden Placement Basics

- Full Sun setting is best
- Select a protected area away from traffic or recreation but convenient to the house or patio for viewing pleasure
- Close to a water source for establishment ease and for bird bath maintenance
- Place taller plants in north-facing position so they will not shade the other plants during the day or in center of bed if not bordered by a fence or home

**UF/IFAS Extension Education Broward County**  
23245 College Avenue Davie, FL 33314-7719  
Phone: (954) 756-8519

<http://sfyl.ifas.ufl.edu/broward/urban-horticulture-and-natural-resources/>

"Pursuant to Section 503 of the Rehabilitation Act of 1973 and the Vietnam Era Veterans Readjustment Assistance Act of 1974 (As Amended) this University of Florida Affirmative Action Plan ensures equal employment opportunity and advancement opportunity to all individuals. The University does not discriminate in employment opportunities or practices on the basis of race, color, religion, sex (including pregnancy, childbirth or related medical conditions), national origin, ancestry, age, disability, family care status, protected veterans status, marital status, sexual orientation or any other characteristic protected by law."