

# Dangerous Plants to Horses in Paddocks and Small Pastures

Florida horse owners who pasture in paddocks or even small pastures need to be aware of plants that present a danger to their horses. Weed control is often the last item on the “to do” list when caring for a horse. This can be a dangerous practice in that some weeds can cause fatal toxic reactions if eaten in certain quantities, at a particular time of the year, or even when a more toxic part of the plant is consumed.

The first point to note is that if certain weeds are edible, then be sure your horse or horses would have already eaten them to the ground. Therefore, if there is a large, unconsumed weed in your pasture tempting your horse every day to take a bite, it is almost certain to be toxic or at the very least unpalatable. I call these weeds “wolf” weeds because they are just waiting for a hungry horse, new fold or a horse new to the paddock to take a taste. This is such a dangerous practice.



## Farm/Ranch Case Studies Series

### Fact Sheet #112513



**Dennis Mudge**  
Extension Agent III  
Livestock/Natural  
Resources/Public Policy

UF/IFAS Extension  
Orange County  
6021 S. Conway Road  
Orlando, FL 32812  
407-254-9200



Drawing by  
**Brent McCallister**  
Landscape Architect  
Orange County Parks &  
Recreation

**UF** | **IFAS Extension**  
UNIVERSITY of FLORIDA





A poorly maintained horse pasture or paddock will have uncontrolled weeds typically in certain locations. Every time a horse owner does this they take a huge risk. Weeds are opportunistic and many are poisonous to horses. Below shows where weeds that poison horses most often occur.

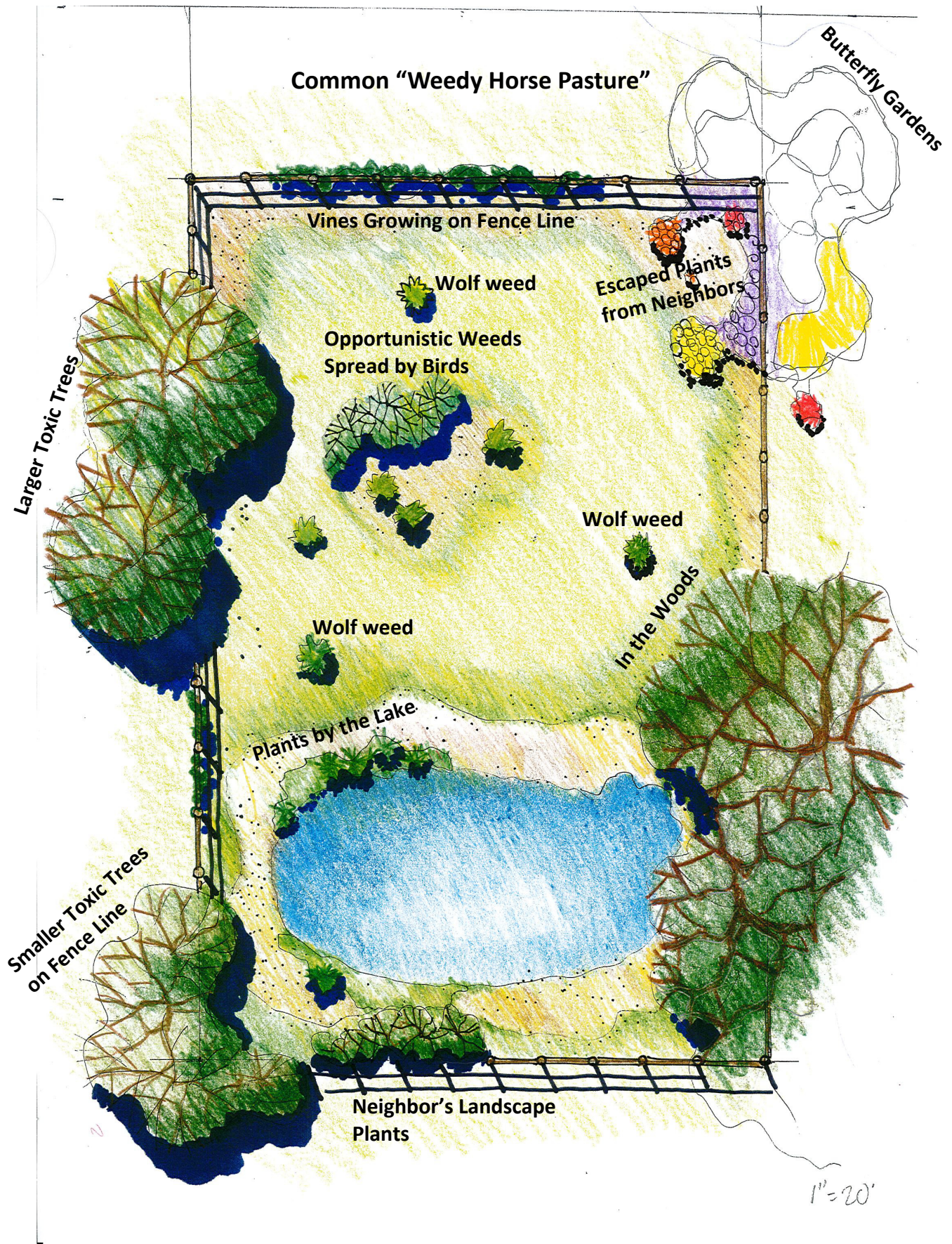



# Common Poisonous Weeds by Location

## By the Lake Front

Sesbania, lilies, horsetail, iris, bladder pod and elderberry.



## Trees That Poison

Chinese tallow, red maple, cherry laurel, chinaberry, golden raintree, black locust and cherry tree.

*Chinese Tallow*

*Crotalaria*



*Cassia*



## Common Landscape Plants that Can Poison

Sago palm, coonties, privet, oleander, crotons, rhododendron, and philodendron.



*Lantana*

## Most Butterfly Garden Plants are Toxic

Milkweed, lantana, cassia, crotalaria, and oleander.

## Toxic Vines

Plants that grow on fence lines and trees such as balsam apply, English ivy, passion fruit, yellow jasmine, ro-sary pea and pathos.

## Opportunistic Toxic Weeds

These weeds just seem to appear in pastures such as black nightshade, tropical soda apple, sickle pod, crotalaria, coffee senna and horse nettle.

## Toxic Plants in Woods

Bracken fern, coral ardesia, jasmine and red root.

## Tree Like but Smaller Poisonous Plants

(Commonly on fence lines) Elderberry, jimson weed, castor bean, spotted hemlock, poison hemlock, poke-weed and cassia.

Poisonous plants commonly grown in pastures to the size of “wolf” weeds are pigweed, black nightshade, lantana, sicklepod, crotalaria, coffee senna, and castor bean.



*Sicklepod*

*Pokeweed*

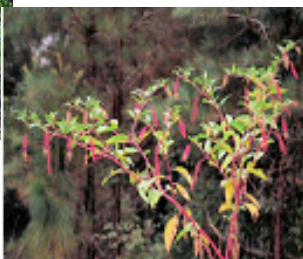

Coffee senna



Coral ardisia



Cherry Laurel

All livestock owners need to take the study of poisonous plant in their pasture seriously. In addition, look at toxic plants online, up close, or invite your local UF/IFAS Extension Agent to walk your pasture to improve your Identification skills.